

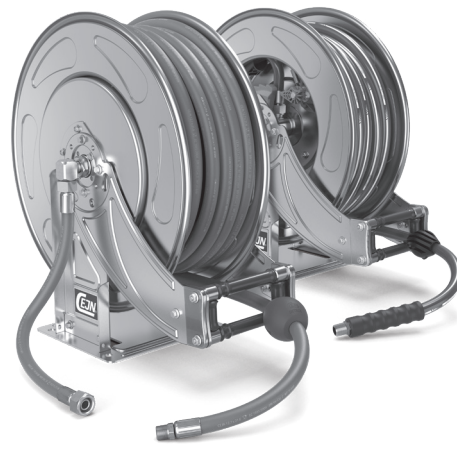

GB

# OpenReel SS hose reels

Series 913 Guide



CEJN AB  
Rattvägen 1  
SE-549 37 Skövde, Sweden  
www.cejn.com



Find instruction videos, guides, and more information about the OpenReel SS hose at [www.cejn.com](http://www.cejn.com).

## 1. Safety IMPORTANT!



- The products are intended for use by knowledgeable persons having the technical skill necessary to evaluate their suitability for specific applications.
- Read all safety instructions carefully before attempting to install, operate or maintain this product.
- Do not leave the hose to coil unattended.
- Only qualified personnel should undertake the installation, commissioning, and maintenance of this product.
- Before carrying out maintenance or repair work, always disconnect the hose reels from the media.
- If the reel must be disassembled, release spring tension before further dismantling.
- Close the feed of fluids at the end of the workday to prevent damages during non-working hours.
- Ensure that the pressure does not exceed the maximum working pressure of the lowest rated system component.
- CEJN AB does not take responsibility for damage that occurs if the reel had been modified or used in a way that was not intended.
- Nor for damages due to incorrect installation or maintenance.

## 2. Intended use of the machine



The hose reels in the powder coated series are suitable for compressed air or different kinds of fluids at low and high temperature. The hose reels in stainless and acid proof steel are suitable for wash down and cleaning applications at high and low temperature. Some versions are fitted with hose suitable for food and beverage industry. Please consider industry-specific regulations regarding cleaning and service instructions for the intended application.

**WARNING! Keep away from moving parts!**

**Wear eye and hearing protection when using the hose reel. Protect your ears from hearing damage and your eyes from flying debris.**



## 3. Installation

Mount the hose reel on stiff and consistent walls, using 4 screws M10. If the hose reel is wall mounted, note that it must be mounted at a minimum of 2,5m from the floor to prevent accidents and injuries during operation.

### 3.1 Assembly

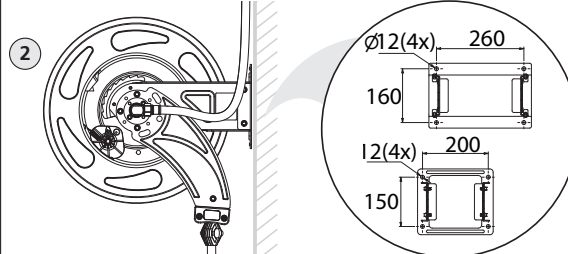
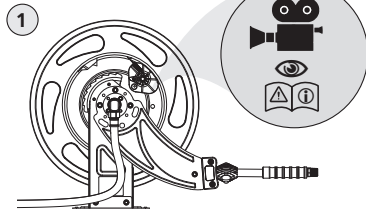

### Mounting-positions

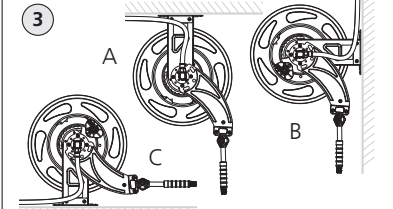

### Arm-positions

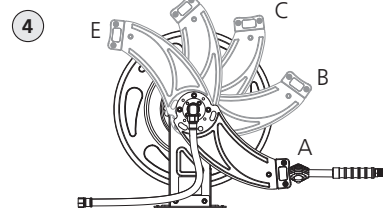

### 3.2 Swing bracket

Swing brackets are available as an accessory, standard reel are fixed 90 degrees from the wall and the swing bracket allow the reel to swing +50 degrees.

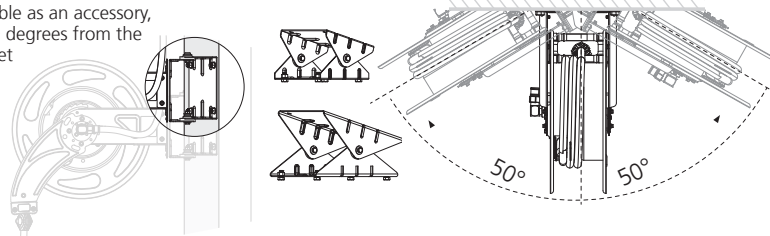

### 3.3 Mounting of the hose (Models without hose)

The hose reels without hose are supplied with the unloaded spring. Use a hose with dimension and pressure characteristics suitable for use according to the hose reel model.

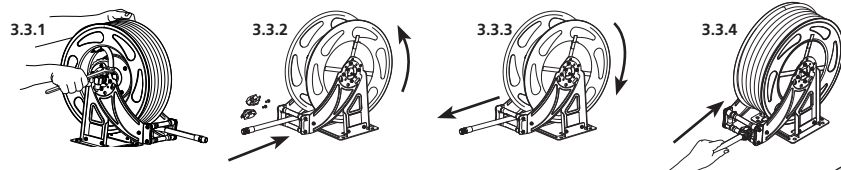

- 3.3.1 Fix the hose reel to the bench. Put the hose between the guide rollers, connect it to the fitting which is inside the drum and tighten by the suitable wrench.
- 3.3.2 Manually rotate the drum in order to completely rewind the hose.
- 3.3.3 To preload the spring hold the hose-end and manually rotate the drum in the opposite direction for a few turns, according to table 13 (last page). Insert the hose-end between the guide rollers again.

- 3.3.4 Put the hose rubber stopper at the desired length.
- 3.3.5 Unwind the hose and rewind it completely, to check if the hose reel works properly.

**DO NOT PUT HANDS OR ANY OTHER THING INSIDE THE DRUM!**



### 3.4 Hose length

The stop ball is allowed to be moved inwards. The spring force can be adjusted.

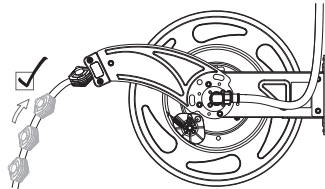

### 3.5 Stop ball detect (For SafetyReel FS)

Make sure the hose and inlay is clean and dry before assembly



**WARNING – Tripping Hazard** Ensure the hose does not create a tripping hazard when extended. Retract the hose after use.  
**CAUTION – Equipment Damage** Clean the hose before retraction to prevent contamination and malfunction.  
**NOTICE – Visibility** The user is responsible for that the work area is well-lit during operation.

## 4. Operation

### 4.1 Pulling out the hose

(1) Pull out the hose to the required length.

(2) To lock the hose, listening for the latch to engage with a “click” while slowly pulling out the hose a small distance.

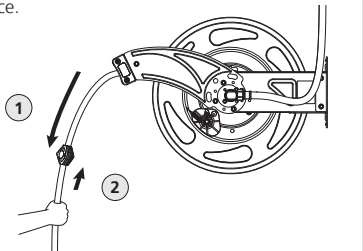

### 4.2 Retracting the hose

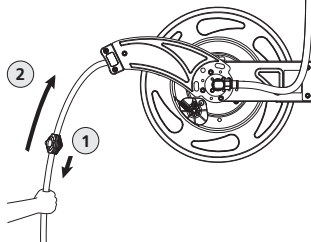

To unlock the hose when you have finished using it,

(1) simply pull it out a small distance and listen for the latch to stop “clicking”.

(2) Then let the hose slowly retract back into the housing. Make sure to always walk the hose back for safe manners.

### WARNING!

Always hold on to the hose and walk it back to the reel. If allowed to rewind freely, personal injury or damage to reel or surroundings could occur.



Find instruction videos how to replace spring and hose and more information about the OpenReel SS hose at [www.cejn.com](http://www.cejn.com).

### 4.3 The hose cannot be fully retracted

If the hose gets jammed when retracted, simply pull out the hose to its full length and let it retract and guide it side to side. If you experience further problems or other malfunctions, contact your local distributor for guidance.

## 9. Replacement of the hose

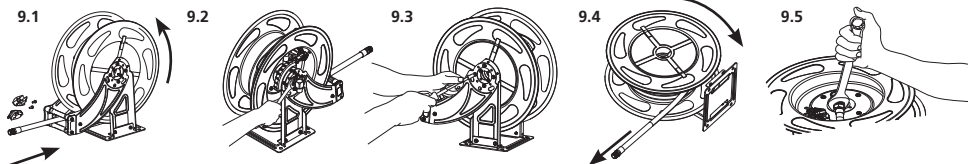

- 9.1 Remove the rubber stopper and release the hose slowly until the spring is completely unloaded.
- 9.2 Loosen the swivel joint.
- 9.3 Loosen the two screws of the spring linkage shaft by a 10 wrench.
- 9.4 Disassemble the opening on the spring side and unwind the hose completely from the drum.
- 9.5 Take out the drum, unscrew the internal fitting with the suitable wrench and mount the new hose.

- 9.6 Assemble the hose reel by following the steps above, in reverse order. If needed, grease the supports and ratchet hooks.
- 9.7 Manually rotate the drum to completely rewind the hose.
- 9.8 Pre-load the spring by holding on to the hose-end and rotate the drum to the opposite direction for a few turns, see table 11.
- 9.9 Insert the hose-end between the guide rollers and put the rubber stopper at desired length.
- 9.10 Unwind the hose completely and rewind it, to make sure that the hose reel works properly.

## 10. Replacement of the spring

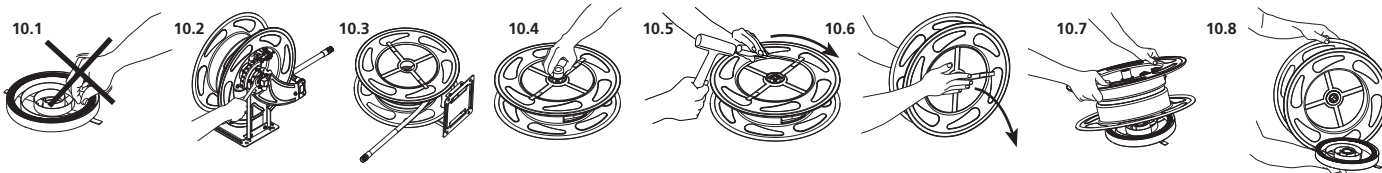

- 10.1 Make sure the spring is totally unloaded and that the drum is free (see point 9.1).
- 10.2 Loosen the swivel joint.
- 10.3 Loosen the two screws of the spring linkage shaft by a 10 wrench.
- 10.4 Disassemble the opening on the spring side and unwind the hose completely from the drum.
- 10.5 Take out the shaft from the spring housing.
- 10.6 Lift the tangs on the drum by using a screwdriver and rotate the spring housing centre to release it from the drum.
- 10.7 Turn the drum upside down and take out the spring housing centre. **IMPORTANT:** Make sure that the spring stays in place in the housing to reduce risk of serious injury.

- 10.8 Insert and hook the shaft into the new spring housing centre. Lubricate the spring and the shaft.
- 10.9 Let the spring house centre lay flat at the table and gently place the drum in position.
- 10.10 Lift the drum and lay it on the other side. Rotate the spring housing to place and gently block the tangs by using a rubber mallet.
- 10.11 Assemble the reel by following above steps in reverse order. And mount the hose by following steps in 9.1 - 9.10 “Replacement of the hose.”

## 11. Technical data

Art. No.	Fluid	Max. pressure (bar)	Inlet	Outlet	Max. hose length (m)	Weight (kg)	Pre-load spring, number of turns
19 913 0000	Air	20	G 3/8" fem	G 1/2" male + (Nipple cone 60°)	25	15	2
19 913 0100	Air, water, oil	20 (air, water) 60 (oil)	G 1/2" male + (Nipple cone 60°)	G 1/2" male + (Nipple cone 60°)	20	19	1
19 913 0103	Air, water, oil	20 (air, water) 60 (oil)	G 1/2" male + (nipple cone 60°)	G 1/2" male + (Nipple cone 60°)	25	19	1
19 913 0200	Air, water, diesel, oil	20	G 1" fem	Ø 19 hose	20	20	1
19 913 1000	Water, air	40	R 1/2" male	G 1/2" male	15	15,5	1
19 913 1100	Water, air	40	R 1/2" male	G 1/2" male	20	20	1
19 913 1106	Water, air	15	G 1" fem	3/4" hose barb	15	21,5	1
19 913 1109	Water, air	40	R 1/2" male	G 1/2" male	25	19	1
19 913 1200	Water, air	15	G 1" fem	3/4" hose barb	20	22	1
19 913 2100	Water, air	400	R 1/2" male	R 1/2" male	25	24	1
19 913 2200	Water, air	40	G 1" fem	R 3/4" male	20	25	1

## 12. Maintenance

- Close the feed of fluid before carrying out any maintenance.
- Ensure that there is no tension in the spring before starting any operations inside the hose reel.
- Carry out regular checks that there are no problems with the hose or external parts.
- Any damage or defects must be repaired immediately.
- Only original spare parts must be used.
- Replace the seal inside the revolving joint in case of losses due to wear and tear.



**IMPORTANT!**  
Any maintenance operation shall be carried out by a suitably trained staff.

## 13. Disposal/Recycling



**IMPORTANT!**  
Help us to take care of the environment. When disposing of the hose reel, please do so in accordance with local environmental regulations.

## 14. Warranty

CEJN AB provides an 18-month warranty from the date of manufacture. Contact your retailer concerning warranty enquiries.

## 15. Spare parts

For safety reasons, only original spare parts must be used.

EC Declaration of Conformity – We declare that the products identified below:  
Hose Reel Type 19 913 0XXX, 19 913 1XXX and 19 913 2XXX conform to: 2006/42/EG (EN ISO 12100:2010)

Marcus Allerbjørn  
Managing Director

CEJN AB



Find instruction videos, guides, and more information about the OpenReel SS hose at [www.cejn.com](http://www.cejn.com).